

Medical Office Space 1901 Brunswick Avenue, Charlotte, NC



CONTACT

Preston "Fred" Griffith
704-332-7173
pgriffith@ecgriffith.us



First Floor Medical Office Space 1901 Brunswick Avenue, Charlotte, NC

- 1,500 - 10,000 sq. ft. available
- Class "A" Medical Office Space
- Available for move in Fall 2009
- Atrium Lobby Exposure
- CMC two blocks walking distance
- Presbyterian Hospital a four minute drive
- Myers Park Address with Midtown Location
- Excellent Clinical Office Layout
- Patient Parking with "no parking deck hassles"
- Located between Kings Drive and Queens Road

Available 704-332-7173

Medical Office Space

1901 Brunswick Avenue, Charlotte, NC

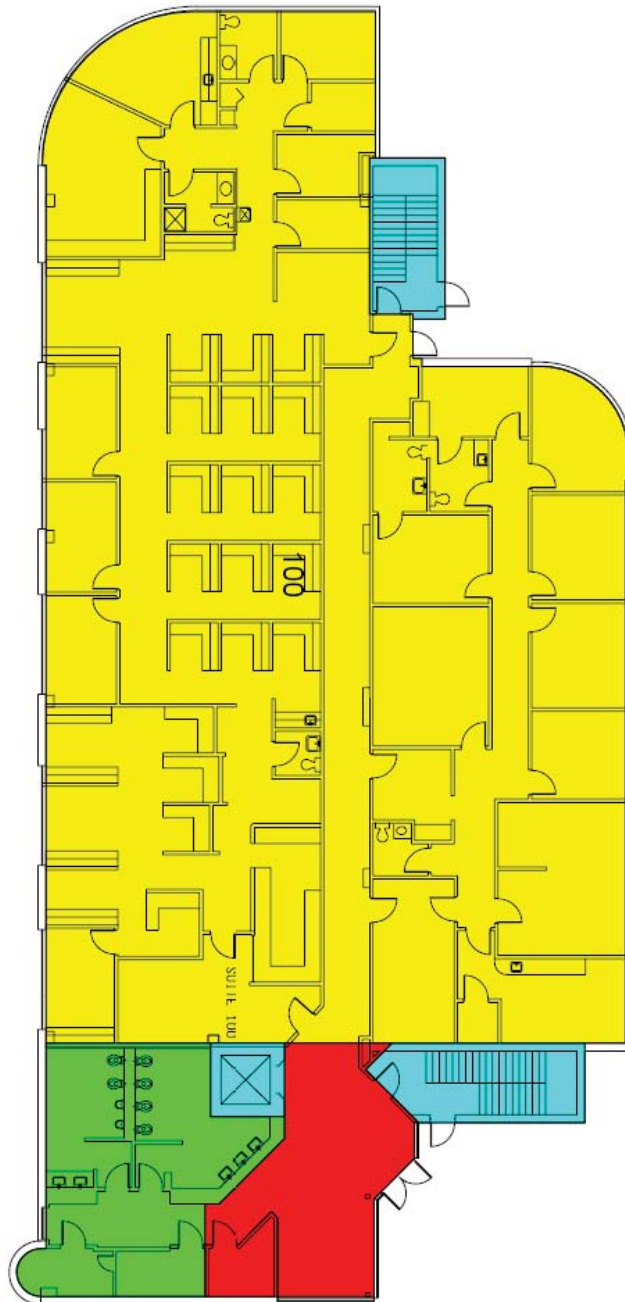

Available 704-332-7173

www.ECGriffith.us